



ROLLED STEEL SECTIONS



APPLICATION

Rolled Steel (RS) and Rolled Steel Channel (RSC) fabricated lintels are designed for extreme loading conditions:

- Masonry loads
- Concrete floor loads
- Attic truss loads
- Point loads: compound trusses, steel beams, etc

ALWAYS CHECK LOADINGS AGAINST OUR LOAD-SPAN TABLE

INSTALLATION NOTES

For general installation notes please refer to page 66.

Additional installation requirements for RS and RSC type lintels

- Lintels must be laterally restrained and adequately propped during construction at maximum 1.2 metre centres. Props should not be removed until the mortar has cured.
- Minimum of 200mm bearing is required
- RSC type lintels - channel MUST be filled with masonry before the work proceeds over and needs to be built tightly against the vertical section of the channel using good quality, well bonded mortar joints.



If in doubt please contact our technical department on 01455 272457

MATERIAL

Lintels are manufactured using 203x133x30kg/m UB or 230x90x32.2kg/m RSC with a 6mm welded bottom plate to BS EN 10025 – 2: 2004 of steel grade S275.

FINISHING

Lintels are coated as standard in a red-oxide paint. However, they can be supplied, at extra cost, with a galvanised finish.

ADVANTAGES

- Available in 50mm increments with a maximum length of 6600mm
- Can suit a variety of cavity wall constructions

ABBREVIATIONS

UDL – Uniform Distributed Load (Serviceable)

RM – Resistance Moment (Serviceable)

SWL – Safe Working Load

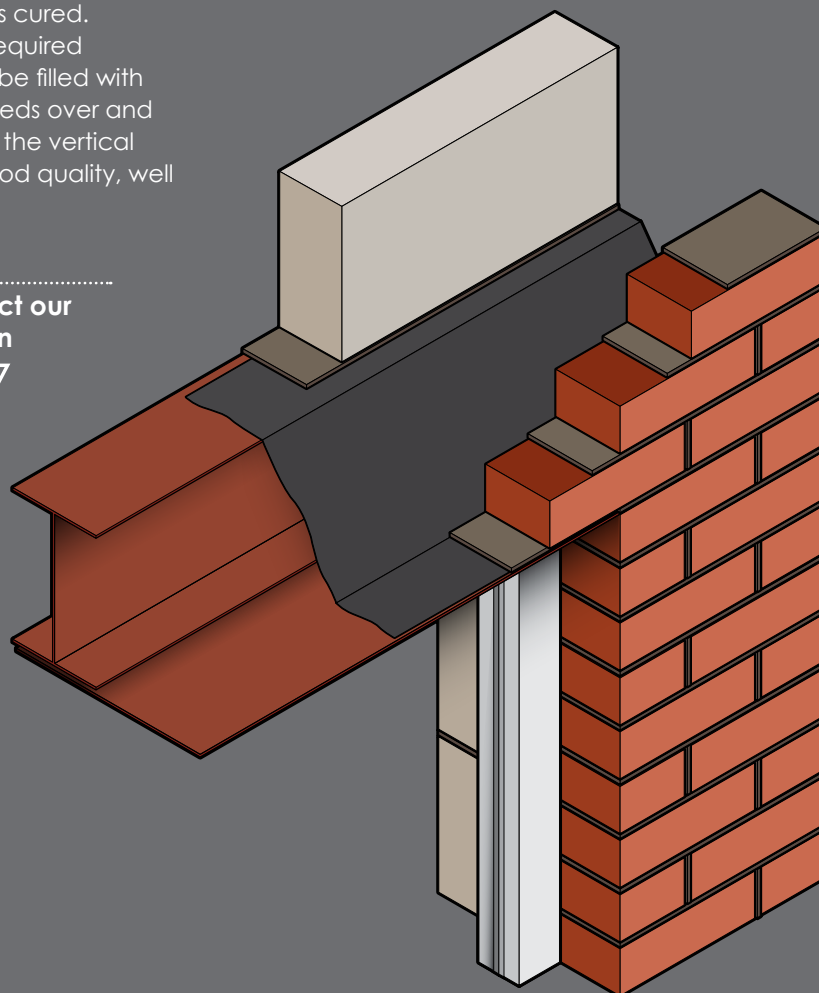

ROLLED STEEL SECTIONS

SL50/RS

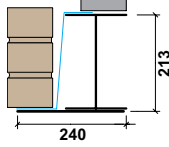

100mm outer leaf
50 - 65mm cavity
100 - 115mm inner leaf

STANDARD LENGTHS (mm)	900	5100	5400	5700	6000	6300	6600
Lintels are available in increments of 50mm	4800						
Nominal Height "h" (mm)	213	213	213	213	213	213	213
Weights (kg/m)	41.3	41.3	41.3	41.3	41.3	41.3	41.3
SWL 5:1/19:1 (kN)	82	77	72	67	64	60	58
RM (kNm)	50.0	50.0	50.0	50.0	50.0	50.0	50.0

See additional installation requirements on page 33.

SL70/RS

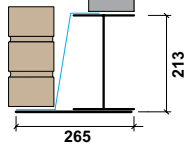

100mm outer leaf
70 - 85mm cavity
100 - 115mm inner leaf

STANDARD LENGTHS (mm)	900	5100	5400	5700	6000	6300	6600
Lintels are available in increments of 50mm	4800						
Nominal Height "h" (mm)	213	213	213	213	213	213	213
Weights (kg/m)	42.2	42.2	42.2	42.2	42.2	42.2	42.2
SWL 5:1/19:1 (kN)	82	77	72	67	64	60	58
RM (kNm)	50.0	50.0	50.0	50.0	50.0	50.0	50.0

See additional installation requirements on page 33.

SL90/RS

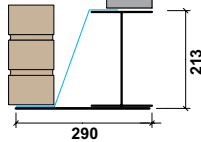

100mm outer leaf
90 - 100mm cavity
100 - 115mm inner leaf

STANDARD LENGTHS (mm)	900	5100	5400	5700	6000	6300	6600
Lintels are available in increments of 50mm	4800						
Nominal Height "h" (mm)	213	213	213	213	213	213	213
Weights (kg/m)	43.2	43.2	43.2	43.2	43.2	43.2	43.2
SWL 5:1/19:1 (kN)	82	77	72	67	64	60	58
RM (kNm)	50.0	50.0	50.0	50.0	50.0	50.0	50.0

See additional installation requirements on page 33.

SL110/RS

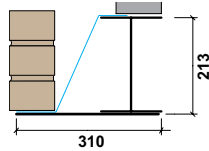

100mm outer leaf
110 - 125mm cavity
100 - 115mm inner leaf

STANDARD LENGTHS (mm)	900	5100	5400	5700	6000	6300	6600
Lintels are available in increments of 50mm	4800						
Nominal Height "h" (mm)	213	213	213	213	213	213	213
Weights (kg/m)	44.1	44.1	44.1	44.1	44.1	44.1	44.1
SWL 5:1/19:1 (kN)	82	77	72	67	64	60	58
RM (kNm)	50.0	50.0	50.0	50.0	50.0	50.0	50.0

See additional installation requirements on page 33.

SL130/RS

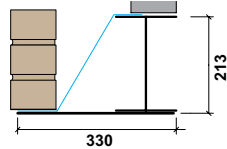

100mm outer leaf
130 - 145mm cavity
100 - 115mm inner leaf

STANDARD LENGTHS (mm)	900	5100	5400	5700	6000	6300	6600
Lintels are available in increments of 50mm	4800						
Nominal Height "h" (mm)	213	213	213	213	213	213	213
Weights (kg/m)	45.1	45.1	45.1	45.1	45.1	45.1	45.1
SWL 5:1/19:1 (kN)	82	77	72	67	64	60	58
RM (kNm)	50.0	50.0	50.0	50.0	50.0	50.0	50.0

See additional installation requirements on page 33.

SL150/RS

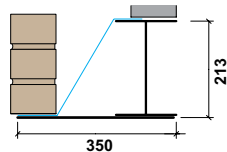

100mm outer leaf
150 - 165mm cavity
100 - 115mm inner leaf

STANDARD LENGTHS (mm)	900	5100	5400	5700	6000	6300	6600
Lintels are available in increments of 50mm	4800						
Nominal Height "h" (mm)	213	213	213	213	213	213	213
Weights (kg/m)	46.0	46.0	46.0	46.0	46.0	46.0	46.0
SWL 5:1/19:1 (kN)	82	77	72	67	64	60	58
RM (kNm)	50.0	50.0	50.0	50.0	50.0	50.0	50.0

See additional installation requirements on page 33.

STANDARD LENGTHS (mm) Lintels are available in increments of 50mm	900 4800	5100	5400	5700	6000	6300	6600
Nominal Height "h" (mm)	236	236	236	236	236	236	236
Weights (kg/m)	44.0	44.0	44.0	44.0	44.0	44.0	44.0
SWL 5:1/19:1 (kN)	95	90	85	80	76	72	69
RM (kNm)	55.7	55.7	55.7	55.7	55.7	55.7	55.7

See additional installation requirements on page 33.

STANDARD LENGTHS (mm) Lintels are available in increments of 50mm	900 4800	5100	5400	5700	6000	6300	6600
Nominal Height "h" (mm)	236	236	236	236	236	236	236
Weights (kg/m)	44.9	44.9	44.9	44.9	44.9	44.9	44.9
SWL 5:1/19:1 (kN)	95	90	85	80	76	72	69
RM (kNm)	55.7	55.7	55.7	55.7	55.7	55.7	55.7

See additional installation requirements on page 33.

STANDARD LENGTHS (mm) Lintels are available in increments of 50mm	900 4800	5100	5400	5700	6000	6300	6600
Nominal Height "h" (mm)	236	236	236	236	236	236	236
Weights (kg/m)	45.9	45.9	45.9	45.9	45.9	45.9	45.9
SWL 5:1/19:1 (kN)	95	90	85	80	76	72	69
RM (kNm)	55.7	55.7	55.7	55.7	55.7	55.7	55.7

See additional installation requirements on page 33.

STANDARD LENGTHS (mm) Lintels are available in increments of 50mm	900 4800	5100	5400	5700	6000	6300	6600
Nominal Height "h" (mm)	236	236	236	236	236	236	236
Weights (kg/m)	46.8	46.8	46.8	46.8	46.8	46.8	46.8
SWL 5:1/19:1 (kN)	95	90	85	80	76	72	69
RM (kNm)	55.7	55.7	55.7	55.7	55.7	55.7	55.7

See additional installation requirements on page 33.

STANDARD LENGTHS (mm) Lintels are available in increments of 50mm	900 4800	5100	5400	5700	6000	6300	6600
Nominal Height "h" (mm)	236	236	236	236	236	236	236
Weights (kg/m)	47.8	47.8	47.8	47.8	47.8	47.8	47.8
SWL 5:1/19:1 (kN)	95	90	85	80	76	72	69
RM (kNm)	55.7	55.7	55.7	55.7	55.7	55.7	55.7

See additional installation requirements on page 33.

STANDARD LENGTHS (mm) Lintels are available in increments of 50mm	900 4800	5100	5400	5700	6000	6300	6600
Nominal Height "h" (mm)	236	236	236	236	236	236	236
Weights (kg/m)	48.7	48.7	48.7	48.7	48.7	48.7	48.7
SWL 5:1/19:1 (kN)	95	90	85	80	76	72	69
RM (kNm)	55.7	55.7	55.7	55.7	55.7	55.7	55.7

See additional installation requirements on page 33.

SL50/RSC

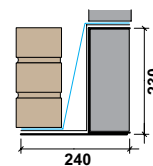

100mm outer leaf
50 - 65mm cavity
100 - 115mm inner leaf

SL70/RSC

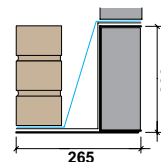

100mm outer leaf
70 - 85mm cavity
100 - 115mm inner leaf

SL90/RSC

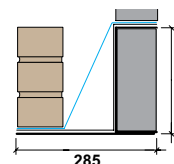

100mm outer leaf
90 - 100mm cavity
100 - 115mm inner leaf

SL110/RSC

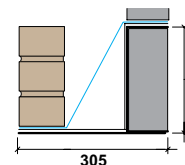

100mm outer leaf
110 - 125mm cavity
100 - 115mm inner leaf

SL130/RSC

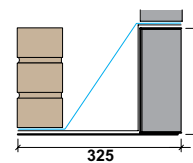

100mm outer leaf
130 - 145mm cavity
100 - 115mm inner leaf

SL150/RSC

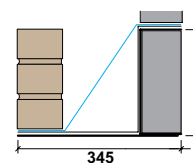

100mm outer leaf
150 - 165mm cavity
100 - 115mm inner leaf