



CAVITY WALL WIDE OUTER LEAF (WOL)



APPLICATION

These lintels are suitable to support a 125-150mm outer leaf of blockwork or stonework.

Standard (WOL) and Heavy Duty (HD WOL & HDX WIL)

Designed to support:

- Masonry loads
- Masonry loads and uniformly distributed timber floor loads
- Uniformly distributed roof loads (in most cases HD lintel type is required)

Extra Heavy Duty (XHD WOL) and Composite Extra Heavy Duty (CXHD WOL)

Designed to support:

- Concrete floor loads
- Attic truss loads
- Point loads: compound trusses, steel beams, etc

ALWAYS CHECK LOADINGS AGAINST OUR LOAD-SPAN TABLE

INSTALLATION NOTES

For general installation notes please refer to page 66.

Additional installation requirements for Composite Extra Heavy Duty (CXHD WOL)

- Ensure that the inner leaf channel is filled with well cured masonry before work proceeds over. Masonry needs to be built tightly against the vertical section of the channel and a mortar joint added to the top of masonry, so that the loads from units above are spread evenly over the inner flange of the lintel.
- Composite lintels should be adequately propped during construction, at maximum 1.2 metre centres. Props should not be removed until the mortar has cured.

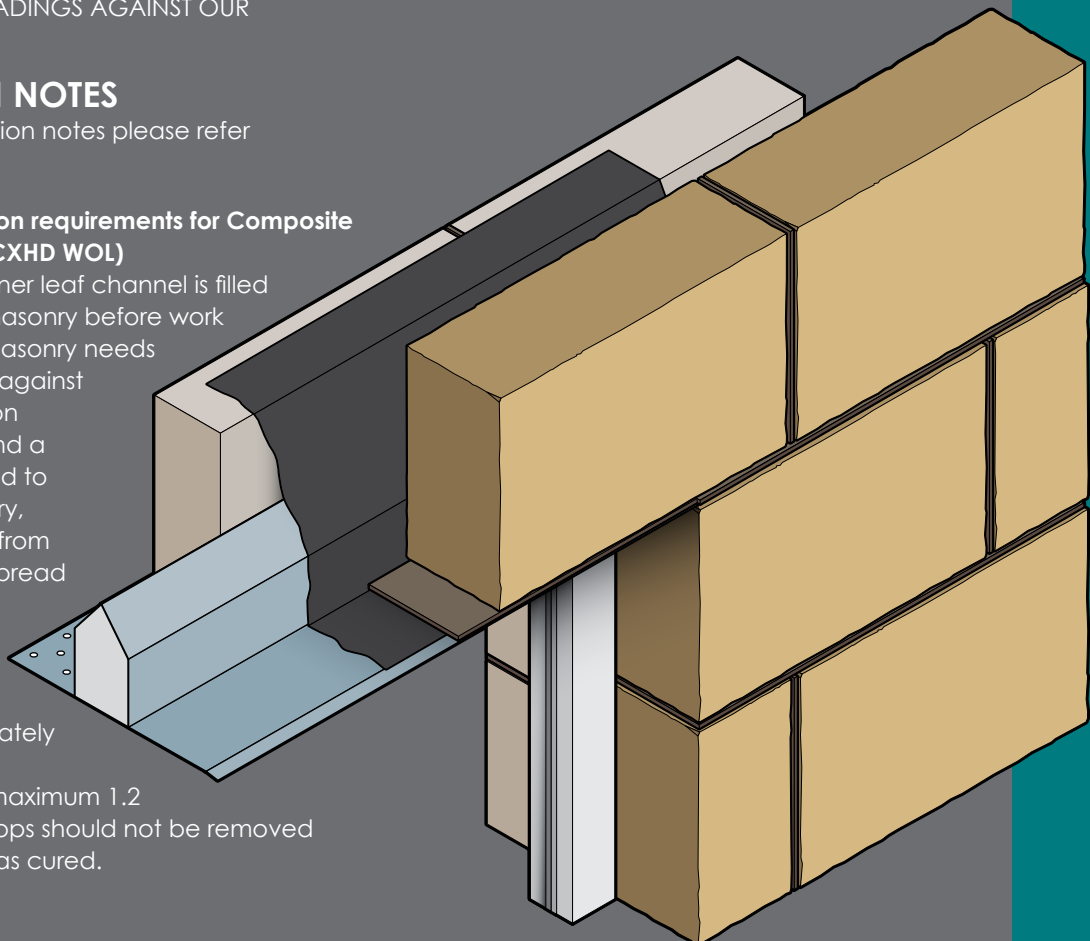

WIDE OUTER LEAF (WOL)

ADVANTAGES

- Easy to install and suitable for a variety of applications
- Galvanised coating ensures durability/longevity
- Built-in plaster key – perforated base plate to inner flange
- Excellent thermal efficiency
- Built-in continuous insulation

ABBREVIATIONS

UDL – Uniform Distributed Load (Serviceable)

RM – Resistance Moment (Serviceable)

SWL – Safe Working Load



If in doubt please contact our technical department on

01455 272457

SL50 WOL

125 -150mm outer leaf
50 - 65mm cavity
100mm inner leaf

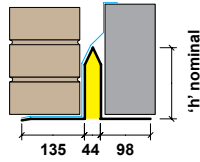

Not suitable to support precast concrete floors, attic trusses, heavy point loads.

STANDARD LENGTHS (mm)	600	1350	1650	1950	2250	2550	3150	3750	4050	4350
Lintels are available in increments of 150mm	1200	1500	1800	2100	2400	3000	3600	3900	4200	4800
Nominal Height "h" (mm)	95	113	134	140	153	190	190	190	225	225
Weights (kg/m)	10.2	11.0	12.0	12.3	13.0	14.7	14.7	14.7	16.4	18.7
SWL 1:1/3:1 (kN)	16	17	22	23	24	28	28	28	28	28
SWL 19:1 (kN)	12	13	17	18	19	22	22	22	22	22
RM (kNm)	3.5	4.5	6.4	7.7	8.8	13.3	13.3	13.3	16.2	16.2

SL50 HD WOL

125 -150mm outer leaf
50 - 65mm cavity
100mm inner leaf

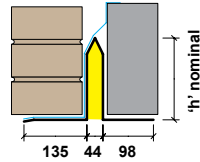

Not suitable to support precast concrete floors, attic trusses, heavy point loads.

STANDARD LENGTHS (mm)	600	1350	1650	2700	3150	3600	4050
Lintels are available in increments of 150mm	1200	1500	2550	3000	3450	3900	4200
Nominal Height "h" (mm)	140	153	190	225	225	225	225
Weights (kg/m)	12.3	13.0	14.7	16.4	16.4	16.4	18.7
SWL 1:1/3:1 (kN)	58	52	41	41	35	33	33
SWL 19:1 (kN)	46	41	32	32	27	26	26
RM (kNm)	7.7	8.8	13.3	15.5	15.5	15.5	16.2

SL50 HDX WOL

125 -150mm outer leaf
50 - 65mm cavity
100mm inner leaf

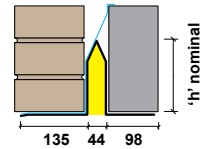

Not suitable to support precast concrete floors, attic trusses, heavy point loads.

STANDARD LENGTHS (mm)	600	1350	1650	1950	2400
Lintels are available in increments of 150mm	1200	1500	1800	2250	2700
Nominal Height "h" (mm)	153	185	190	225	225
Weights (kg/m)	13.0	14.5	14.7	16.4	18.7
SWL 1:1/3:1 (kN)	67	58	64	59	50
SWL 19:1 (kN)	52	46	50	46	39
RM (kNm)	8.8	9.9	13.3	15.5	16.2

SL50 XHD 225 WOL

125 -150mm outer leaf
50 - 65mm cavity
100mm inner leaf

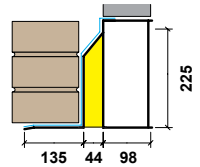

Suitable to support precast concrete floors, attic trusses, and point loads.

STANDARD LENGTHS (mm)	600	2250	2850	3450	4050
Lintels are available in increments of 150mm	2100	2700	3300	3900	4200
Nominal Height "h" (mm)	225	225	225	225	225
Weights (kg/m)	27.1	27.1	27.1	27.1	27.1
SWL 5:1 (kN)	79	60	49	41	40
SWL 19:1 (kN)	66	51	41	34	33
RM (kNm)	20.6	20.6	20.6	20.6	20.6

SL50 CXHD 150 WOL

125 -150mm outer leaf
50 - 65mm cavity
100mm inner leaf

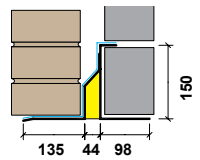

Suitable to support precast concrete floors, attic trusses, and point loads.

STANDARD LENGTHS (mm)	600	1950	2250	2550
Lintels are available in increments of 150mm	1800	2100	2400	2700
Nominal Height "h" (mm)	156	156	156	156
Weights (kg/m)	16.2	16.2	16.2	16.2
SWL 5:1 (kN)	72	62	53	41
SWL 19:1 (kN)	61	52	45	34
RM (kNm)	12.6	12.6	12.6	12.6

See additional installation requirements on page 19.

SL50 CXHD 225 WOL

125 -150mm outer leaf
50 - 65mm cavity
100mm inner leaf

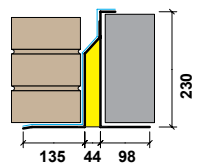

Suitable to support precast concrete floors, attic trusses, and point loads.

STANDARD LENGTHS (mm)	600	1950	3150	4050	4650	4950
Lintels are available in increments of 150mm	1800	3000	3900	4500	4800	5100
Nominal Height "h" (mm)	236	236	236	236	236	236
Weights (kg/m)	19.9	19.9	19.9	19.9	19.9	19.9
SWL 5:1 (kN)	89	71	55	42	37	32
SWL 19:1 (kN)	75	60	46	40	35	30
RM (kNm)	21.5	21.5	21.5	20.5	20.5	20.5

See additional installation requirements on page 19.

STANDARD LENGTHS (mm) Lintels are available in increments of 150mm	600 1200	1350 1500	1650 1800	1950 2100	2250 2400	2550 3000	3150 3600	3750 3900	4050 4200	4350 4800
Nominal Height "h" (mm)	95	113	134	140	153	190	190	190	225	225
Weights (kg/m)	10.4	11.3	12.3	12.6	13.2	15.0	15.0	15.0	16.6	19.4
SWL 1:1/3:1 (kN)	16	17	22	23	24	28	28	28	28	28
SWL 19:1 (kN)	12	13	17	18	19	22	22	22	22	22
RM (kNm)	3.5	4.5	6.4	7.7	8.8	13.3	13.3	13.3	16.2	16.2

STANDARD LENGTHS (mm) Lintels are available in increments of 150mm	600 1200	1350 1500	1650 2550	2700 3000	3150 3450	3600 3900	4050 4200
Nominal Height "h" (mm)	140	153	190	225	225	225	225
Weights (kg/m)	12.6	13.2	15.0	16.6	16.6	16.6	19.4
SWL 1:1/3:1 (kN)	58	52	41	41	35	33	33
SWL 19:1 (kN)	46	41	32	32	27	26	26
RM (kNm)	7.7	8.8	13.3	15.5	15.5	15.5	16.2

STANDARD LENGTHS (mm) Lintels are available in increments of 150mm	600 1200	1350 1500	1650 1800	1950 2250	2400 2700
Nominal Height "h" (mm)	153	185	190	225	225
Weights (kg/m)	13.2	14.7	15.0	16.6	19.4
SWL 1:1/3:1 (kN)	67	58	64	59	50
SWL 19:1 (kN)	52	46	50	46	39
RM (kNm)	8.8	9.9	13.3	15.5	16.2

STANDARD LENGTHS (mm) Lintels are available in increments of 150mm	600 2100	2250 2700	2850 3300	3450 3900	4050 4200
Nominal Height "h" (mm)	225	225	225	225	225
Weights (kg/m)	27.9	27.9	27.9	27.9	27.9
SWL 5:1 (kN)	79	60	49	41	40
SWL 19:1 (kN)	66	51	41	34	33
RM (kNm)	20.6	20.6	20.6	20.6	20.6

STANDARD LENGTHS (mm) Lintels are available in increments of 150mm	600 1800	1950 2100	2250 2400	2550 2700
Nominal Height "h" (mm)	156	156	156	156
Weights (kg/m)	17.0	17.0	17.0	16.2
SWL 5:1 (kN)	72	62	53	41
SWL 19:1 (kN)	61	52	45	34
RM (kNm)	12.6	12.6	12.6	12.6

See additional installation requirements on page 19.

STANDARD LENGTHS (mm) Lintels are available in increments of 150mm	600 1800	1950 3000	3150 3900	4050 4500	4650 4800	4950 5100
Nominal Height "h" (mm)	236	236	236	236	236	236
Weights (kg/m)	20.8	20.8	20.8	20.8	20.8	19.9
SWL 5:1 (kN)	89	71	55	37	37	32
SWL 19:1 (kN)	75	60	46	35	35	30
RM (kNm)	21.5	21.5	21.5	20.5	20.5	20.5

See additional installation requirements on page 19.

SL70 WOL

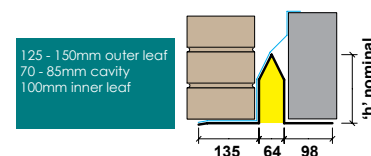

Not suitable to support precast concrete floors, attic trusses, heavy point loads.

SL70 HD WOL

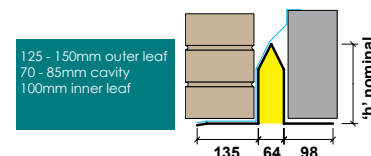

Not suitable to support precast concrete floors, attic trusses, heavy point loads.

SL70 HDX WOL

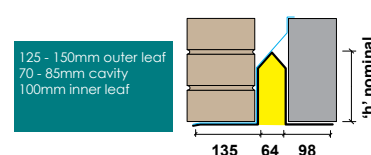

Not suitable to support precast concrete floors, attic trusses, heavy point loads.

SL70 XHD 225 WOL

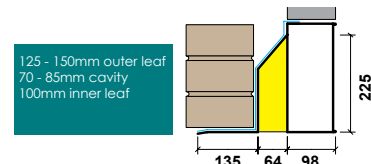

Suitable to support precast concrete floors, attic trusses, and point loads.

SL70 CXHD 150 WOL

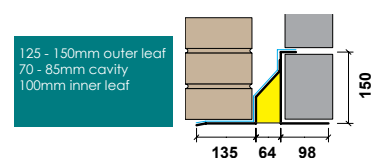

Suitable to support precast concrete floors, attic trusses, and point loads.

SL70 CXHD 225 WOL

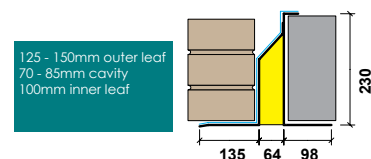

Suitable to support precast concrete floors, attic trusses, and point loads.

SL90 WOL

125 - 150mm outer leaf
90 - 105mm cavity
100mm inner leaf

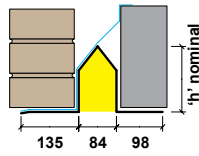

Not suitable to support precast concrete floors, attic trusses, heavy point loads.

STANDARD LENGTHS (mm)	600	1350	1650	1950	2250	2550	3150	3750	4050	4350
Lintels are available in increments of 150mm	1200	1500	1800	2100	2400	3000	3600	3900	4200	4800
Nominal Height "h" (mm)	95	113	134	140	153	190	190	190	225	225
Weights (kg/m)	10.7	11.6	12.6	12.9	13.5	15.3	15.3	15.3	16.9	20.2
SWL 1:1/3:1 (kN)	16	17	22	23	24	28	28	28	28	28
SWL 19:1 (kN)	12	13	17	18	19	22	22	22	22	22
RM (kNm)	3.5	4.5	6.4	7.7	8.8	13.3	13.3	13.3	16.2	16.2

SL90 HD WOL

125 - 150mm outer leaf
90 - 105mm cavity
100mm inner leaf

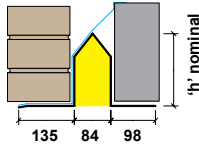

Not suitable to support precast concrete floors, attic trusses, heavy point loads.

STANDARD LENGTHS (mm)	600	1350	1650	2700	3150	3600	4050
Lintels are available in increments of 150mm	1200	1500	2550	3000	3450	3900	4200
Nominal Height "h" (mm)	140	153	190	225	225	225	225
Weights (kg/m)	12.9	13.5	15.3	16.9	16.9	16.9	20.2
SWL 1:1/3:1 (kN)	58	52	41	41	35	33	33
SWL 19:1 (kN)	46	41	32	32	27	26	26
RM (kNm)	7.7	8.8	13.3	15.5	15.5	15.5	16.2

SL90 HDX WOL

125 - 150mm outer leaf
90 - 105mm cavity
100mm inner leaf

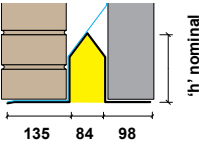

Not suitable to support precast concrete floors, attic trusses, heavy point loads.

STANDARD LENGTHS (mm)	600	1350	1650	1950	2400
Lintels are available in increments of 150mm	1200	1500	1800	2250	2700
Nominal Height "h" (mm)	153	185	190	225	225
Weights (kg/m)	13.5	15.0	15.3	16.9	20.2
SWL 1:1/3:1 (kN)	67	58	64	59	50
SWL 19:1 (kN)	52	46	50	46	39
RM (kNm)	8.8	9.9	13.3	15.5	16.2

SL90 XHD 225 WOL

125 - 150mm outer leaf
90 - 105mm cavity
100mm inner leaf

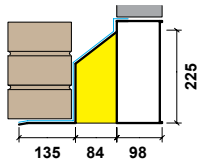

Suitable to support precast concrete floors, attic trusses, and point loads.

STANDARD LENGTHS (mm)	600	2250	2850	3450	4050
Lintels are available in increments of 150mm	2100	2700	3300	3900	4200
Nominal Height "h" (mm)	225	225	225	225	225
Weights (kg/m)	28.7	28.7	28.7	28.7	28.7
SWL 5:1 (kN)	79	60	49	41	40
SWL 19:1 (kN)	66	51	41	34	33
RM (kNm)	20.6	20.6	20.6	20.6	20.6

SL90 CXHD 150 WOL

125 - 150mm outer leaf
90 - 105mm cavity
100mm inner leaf

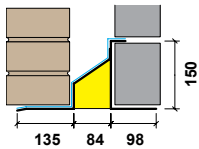

Suitable to support precast concrete floors, attic trusses, and point loads.

STANDARD LENGTHS (mm)	600	1950	2250	2550
Lintels are available in increments of 150mm	1800	2100	2400	2700
Nominal Height "h" (mm)	156	156	156	156
Weights (kg/m)	17.9	17.9	17.9	16.2
SWL 5:1 (kN)	72	62	53	41
SWL 19:1 (kN)	61	52	45	34
RM (kNm)	12.6	12.6	12.6	12.6

See additional installation requirements on page 19.

SL90 CXHD 225 WOL

125 - 150mm outer leaf
90 - 105mm cavity
100mm inner leaf

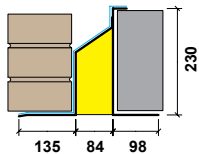

Suitable to support precast concrete floors, attic trusses, and point loads.

STANDARD LENGTHS (mm)	600	1950	3150	4050	4650	4950
Lintels are available in increments of 150mm	1800	3000	3900	4500	4800	5100
Nominal Height "h" (mm)	236	236	236	236	236	236
Weights (kg/m)	21.6	21.6	21.6	21.6	21.6	19.9
SWL 5:1 (kN)	89	71	55	42	37	32
SWL 19:1 (kN)	75	60	46	40	35	30
RM (kNm)	21.5	21.5	21.5	20.5	20.5	20.5

See additional installation requirements on page 19.

STANDARD LENGTHS (mm) Lintels are available in increments of 150mm	600 1200	1350 1500	1650 1800	1950 2100	2250 2400	2550 3000	3150 3600	3750 3900	4050 4200	4350 4800
Nominal Height "h" (mm)	95	113	134	140	153	190	190	190	225	225
Weights (kg/m)	11.5	12.4	13.4	13.7	14.3	16.1	16.1	16.1	17.7	21.5
SWL 1:1/3:1 (kN)	26	26	31	31	31	37	30	28	28	28
SWL 19:1 (kN)	20	20	24	24	24	29	23	22	22	22
RM (kNm)	3.5	4.5	6.4	7.7	8.8	13.3	13.3	13.3	16.2	16.2

SL110 WOL

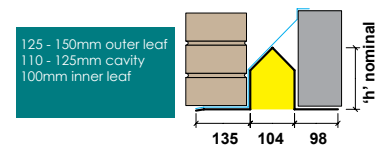

Not suitable to support precast concrete floors, attic trusses, heavy point loads.

STANDARD LENGTHS (mm) Lintels are available in increments of 150mm	600 1200	1350 1500	1650 2550	2700 3000	3150 3450	3600 3900	4050 4200
Nominal Height "h" (mm)	140	153	190	225	225	225	225
Weights (kg/m)	13.7	14.3	16.1	17.7	17.7	17.7	21.5
SWL 1:1/3:1 (kN)	58	52	41	41	35	33	33
SWL 19:1 (kN)	46	41	32	32	27	26	26
RM (kNm)	7.7	8.8	13.3	15.5	15.5	15.5	16.2

SL110 HD WOL

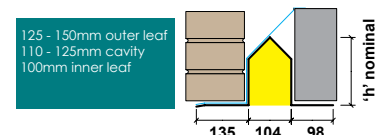

Not suitable to support precast concrete floors, attic trusses, heavy point loads.

STANDARD LENGTHS (mm) Lintels are available in increments of 150mm	600 1200	1350 1500	1650 1800	1950 2250	2400 2700
Nominal Height "h" (mm)	153	185	190	225	225
Weights (kg/m)	14.3	15.8	16.1	17.7	21.5
SWL 1:1/3:1 (kN)	67	58	64	59	50
SWL 19:1 (kN)	52	46	50	46	39
RM (kNm)	8.8	9.9	13.3	15.5	16.2

SL110 HDX WOL

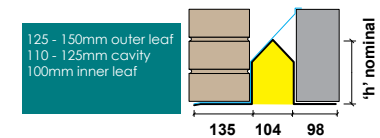

Not suitable to support precast concrete floors, attic trusses, heavy point loads.

STANDARD LENGTHS (mm) Lintels are available in increments of 150mm	600 2100	2250 2700	2850 3300	3450 3900	4050 4200
Nominal Height "h" (mm)	225	225	225	225	225
Weights (kg/m)	29.7	29.7	29.7	29.7	29.7
SWL 5:1 (kN)	79	60	49	41	40
SWL 19:1 (kN)	66	51	41	34	33
RM (kNm)	20.6	20.6	20.6	20.6	20.6

SL110 XHD 225 WOL

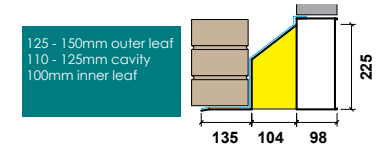

Suitable to support precast concrete floors, attic trusses, and point loads.

STANDARD LENGTHS (mm) Lintels are available in increments of 150mm	600 1800	1950 2100	2250 2400	2550 2700
Nominal Height "h" (mm)	156	156	156	156
Weights (kg/m)	18.8	18.8	18.8	16.2
SWL 5:1 (kN)	72	62	53	41
SWL 19:1 (kN)	61	52	45	34
RM (kNm)	12.6	12.6	12.6	12.6

SL110 CXHD 150 WOL

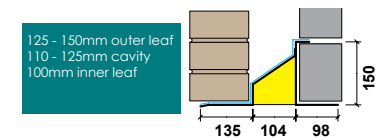

Suitable to support precast concrete floors, attic trusses, and point loads.

See additional installation requirements on page 19.

STANDARD LENGTHS (mm) Lintels are available in increments of 150mm	600 1800	1950 3000	3150 3900	4050 4500	4650 4800	4950 5100
Nominal Height "h" (mm)	236	236	236	236	236	236
Weights (kg/m)	22.5	22.5	22.5	22.5	22.5	19.9
SWL 5:1 (kN)	89	71	55	37	37	32
SWL 19:1 (kN)	75	60	46	35	35	30
RM (kNm)	21.5	21.5	21.5	20.5	20.5	20.5

SL110 CXHD 225 WOL

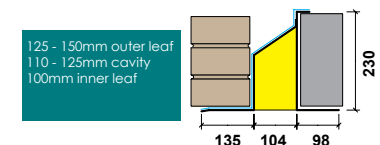

Suitable to support precast concrete floors, attic trusses, and point loads.

See additional installation requirements on page 19.

SL130 WOL

125 - 150mm outer leaf
130 - 145mm cavity
100mm inner leaf

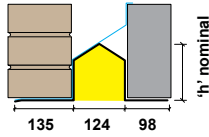

Not suitable to support precast concrete floors, attic trusses, heavy point loads.

STANDARD LENGTHS (mm)	600	1350	1650	1950	2250	2550	3150	3750	4050	4350
Lintels are available in increments of 150mm										
Nominal Height "h" (mm)	1200	1500	1800	2100	2400	3000	3600	3900	4200	4800
Weights (kg/m)	95	113	134	140	153	190	190	190	225	225
SWL 1:1/3:1 (kN)	11.9	12.7	13.7	14.0	14.6	16.4	16.4	16.4	18.1	22.3
SWL 19:1 (kN)	16	17	22	23	24	28	28	28	28	28
SWL 19:1 (kN)	12	13	17	18	19	22	22	22	22	22
RM (kNm)	3.5	4.5	6.4	7.7	8.8	13.3	13.3	13.3	16.2	16.2

SL130 HD WOL

125 - 150mm outer leaf
130 - 145mm cavity
100mm inner leaf

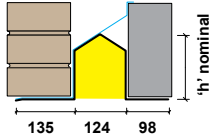

Not suitable to support precast concrete floors, attic trusses, heavy point loads.

STANDARD LENGTHS (mm)	600	1350	1650	2700	3150	3600	4050
Lintels are available in increments of 150mm							
Nominal Height "h" (mm)	1200	1500	2550	3000	3450	3900	4200
Weights (kg/m)	140	153	190	225	225	225	225
Weights (kg/m)	14.0	14.6	16.4	18.1	18.1	18.1	22.3
SWL 1:1/3:1 (kN)	58	52	41	41	35	33	33
SWL 19:1 (kN)	46	41	32	32	27	26	26
RM (kNm)	7.7	8.8	13.3	15.5	15.5	15.5	16.2

SL130 HDX WOL

125 - 150mm outer leaf
130 - 145mm cavity
100mm inner leaf

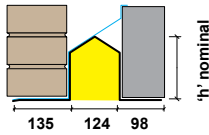

Not suitable to support precast concrete floors, attic trusses, heavy point loads.

STANDARD LENGTHS (mm)	600	1350	1650	1950	2400
Lintels are available in increments of 150mm					
Nominal Height "h" (mm)	1200	1500	1800	2250	2700
Weights (kg/m)	153	185	190	225	225
Weights (kg/m)	14.6	16.2	16.4	18.1	18.7
SWL 1:1/3:1 (kN)	67	58	64	63	50
SWL 19:1 (kN)	52	46	50	49	39
RM (kNm)	8.8	9.9	13.3	15.5	16.2

SL130 XHD 225 WOL

125 - 150mm outer leaf
130 - 145mm cavity
100mm inner leaf

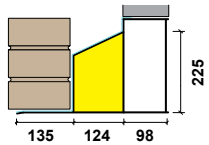

Suitable to support precast concrete floors, attic trusses, and point loads.

STANDARD LENGTHS (mm)	600	2250	2850	3450	4050
Lintels are available in increments of 150mm					
Nominal Height "h" (mm)	2100	2700	3300	3900	4200
Weights (kg/m)	225	225	225	225	225
Weights (kg/m)	30.6	30.6	30.6	30.6	30.6
SWL 5:1 (kN)	79	60	49	41	40
SWL 19:1 (kN)	66	51	41	34	33
RM (kNm)	20.6	20.6	20.6	20.6	20.6

SL130 CXHD 150 WOL

125 - 150mm outer leaf
130 - 145mm cavity
100mm inner leaf

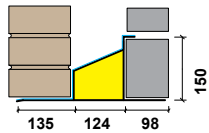

Suitable to support precast concrete floors, attic trusses, and point loads.

STANDARD LENGTHS (mm)	600	1950	2250	2550
Lintels are available in increments of 150mm				
Nominal Height "h" (mm)	1800	2100	2400	2700
Weights (kg/m)	156	156	156	156
Weights (kg/m)	19.7	19.7	19.7	16.2
SWL 5:1 (kN)	72	62	53	41
SWL 19:1 (kN)	61	52	45	34
RM (kNm)	12.6	12.6	12.6	12.6

SL130 CXHD 225 WOL

125 - 150mm outer leaf
130 - 145mm cavity
100mm inner leaf

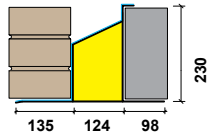

Suitable to support precast concrete floors, attic trusses, and point loads.

STANDARD LENGTHS (mm)	600	1950	3150	4050	4650	4950
Lintels are available in increments of 150mm						
Nominal Height "h" (mm)	1800	3000	3900	4500	4800	5100
Weights (kg/m)	236	236	236	236	236	236
Weights (kg/m)	23.4	23.4	23.4	23.4	23.4	19.9
SWL 5:1 (kN)	89	71	55	42	37	32
SWL 19:1 (kN)	75	60	46	40	35	30
RM (kNm)	21.5	21.5	21.5	20.5	20.5	20.5

STANDARD LENGTHS (mm) Lintels are available in increments of 150mm	600 1200	1350 1500	1650 1800	1950 2100	2250 2400	2550 3000	3150 3600	3750 3900	4050 4200	4350 4800
Nominal Height "h" (mm)	95	113	134	140	153	190	190	190	225	225
Weights (kg/m)	12.3	13.1	14.1	14.4	15.1	16.8	16.8	16.8	18.5	23.2
SWL 1:1/3:1 (kN)	16	17	22	23	24	28	28	28	28	28
SWL 19:1 (kN)	12	13	17	18	19	22	22	22	22	22
RM (kNm)	3.5	4.5	6.4	7.7	8.8	13.3	13.3	13.3	16.2	16.2

SL150 WOL

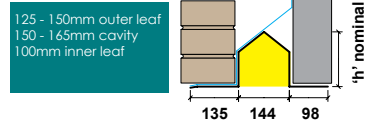

Not suitable to support precast concrete floors, attic trusses, heavy point loads.

STANDARD LENGTHS (mm) Lintels are available in increments of 150mm	600 1200	1350 1500	1650 2550	2700 3000	3150 3450	3600 3900	4050 4200
Nominal Height "h" (mm)	140	153	190	225	225	225	225
Weights (kg/m)	14.4	15.1	16.8	18.5	18.5	18.5	23.2
SWL 1:1/3:1 (kN)	58	52	41	41	35	33	33
SWL 19:1 (kN)	46	41	32	32	27	26	26
RM (kNm)	7.7	8.8	13.3	15.5	15.5	15.5	16.2

SL150 HD WOL

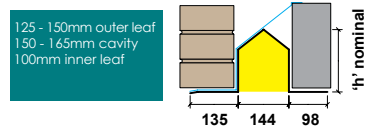

Not suitable to support precast concrete floors, attic trusses, heavy point loads.

STANDARD LENGTHS (mm) Lintels are available in increments of 150mm	600 1200	1350 1500	1650 1800	1950 2250	2400 2700
Nominal Height "h" (mm)	153	185	190	225	225
Weights (kg/m)	15.1	16.6	18.5	18.5	23.2
SWL 1:1/3:1 (kN)	67	58	64	59	50
SWL 19:1 (kN)	52	46	50	46	39
RM (kNm)	8.8	9.9	13.3	15.5	16.2

SL150 HDX WOL

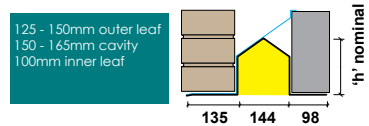

Not suitable to support precast concrete floors, attic trusses, heavy point loads.

STANDARD LENGTHS (mm) Lintels are available in increments of 150mm	600 2100	2250 2700	2850 3300	3450 3900	4050 4200
Nominal Height "h" (mm)	225	225	225	225	225
Weights (kg/m)	31.5	31.5	31.5	31.5	31.5
SWL 5:1 (kN)	79	60	49	41	40
SWL 19:1 (kN)	66	51	41	34	33
RM (kNm)	20.6	20.6	20.6	20.6	20.6

SL150 XHD 225 WOL

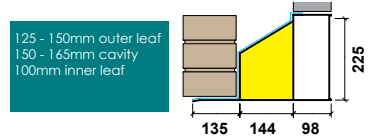

Suitable to support precast concrete floors, attic trusses, and point loads.

STANDARD LENGTHS (mm) Lintels are available in increments of 150mm	600 1800	1950 2100	2250 2400	2550 2700
Nominal Height "h" (mm)	156	156	156	156
Weights (kg/m)	20.6	20.6	20.6	16.2
SWL 5:1 (kN)	72	62	53	41
SWL 19:1 (kN)	61	52	45	34
RM (kNm)	12.6	12.6	12.6	12.6

SL150 CXHD 150 WOL

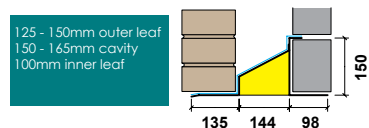

Suitable to support precast concrete floors, attic trusses, and point loads.

See additional installation requirements on page 19.

STANDARD LENGTHS (mm) Lintels are available in increments of 150mm	600 1800	1950 3000	3150 3900	4050 4500	4650 4800	4950 5100
Nominal Height "h" (mm)	236	236	236	236	236	236
Weights (kg/m)	24.3	24.3	24.3	24.3	24.3	19.9
SWL 5:1 (kN)	89	71	55	42	37	32
SWL 19:1 (kN)	75	60	46	40	35	30
RM (kNm)	21.5	21.5	21.5	20.5	20.5	20.5

SL150 CXHD 225 WOL

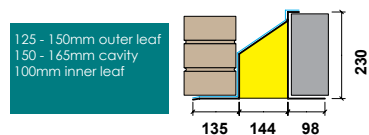

Suitable to support precast concrete floors, attic trusses, and point loads.

See additional installation requirements on page 19.