



CAVITY WALL WIDE INNER LEAF (WIL)



APPLICATION

These lintels are suitable to support a 125-150mm inner leaf of blockwork.

Standard (WIL) and Heavy Duty (HD WIL & HDX WIL)

Designed to support:

- Masonry loads
- Masonry loads and uniformly distributed timber floor loads
- Uniformly distributed roof loads (in most cases HD lintel type is required)

Extra Heavy Duty (XHD WIL) and Composite Extra Heavy Duty (CXHD WIL)

Designed to support:

- Concrete floor loads
- Attic truss loads
- Point loads: compound trusses, steel beams, etc

ALWAYS CHECK LOADINGS AGAINST OUR LOAD-SPAN TABLE

INSTALLATION NOTES

For general installation notes please refer to page 66.

Additional installation requirements for Composite Extra Heavy Duty (CXHD WIL)

- Ensure that the inner leaf channel is filled with well cured masonry before work proceeds over. Masonry needs to be built tightly against the vertical section of the channel and a mortar joint added to the top of masonry, so that the loads from units above are spread evenly over the inner flange of the lintel.
- Composite lintels should be adequately propped during construction, at maximum 1.2 metre centres. Props should not be removed until the mortar has cured.

ADVANTAGES:

- Easy to install and suitable for a variety of applications
- Galvanised coating ensures durability/longevity
- Built-in plaster key – perforated base plate to inner flange
- Excellent thermal efficiency
- Built-in continuous insulation
- Can be manufactured with a short/reduced outer toe (SOL) to suit a cant brick detail or feature stone head.

ABBREVIATIONS

UDL – Uniform Distributed Load (Serviceable)

RM – Resistance Moment (Serviceable)

SWL – Safe Working Load



If in doubt please contact our technical department on

01455 272457

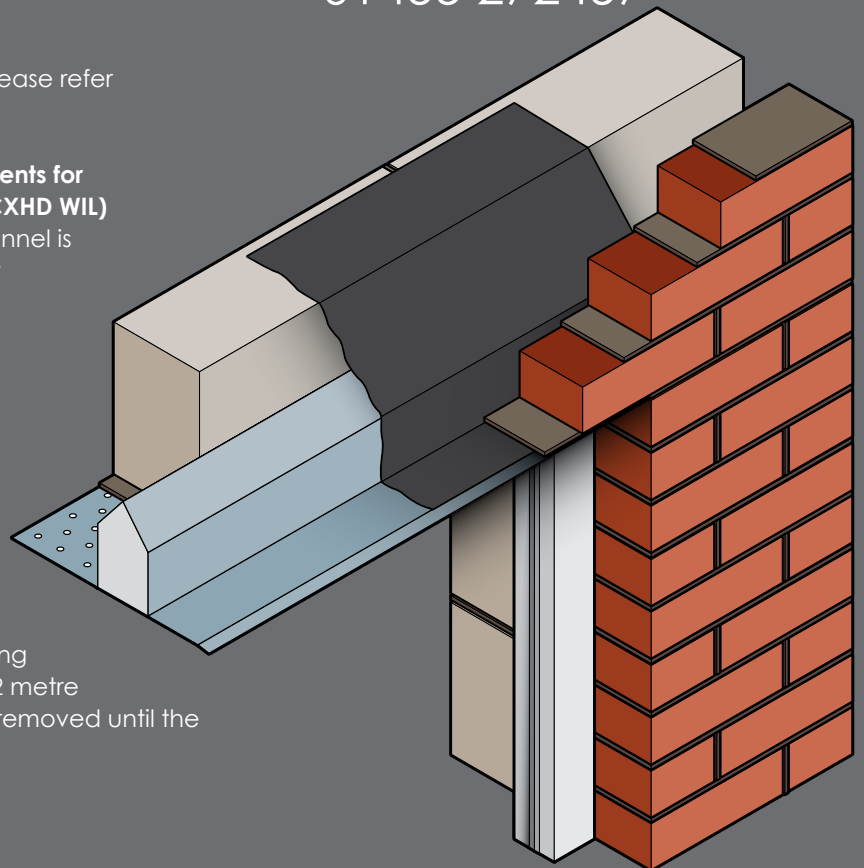

WIDE INNER LEAF (WIL)

STANDARD LENGTHS (mm) Lintels are available in increments of 150mm	600 1200	1350 1500	1650 1800	1950 2100	2250 2400	2550 3000	3150 3600	3750 3900	4050 4200	4350 4800
Nominal Height "h" (mm)	95	113	134	140	153	190	190	190	225	225
Weights (kg/m)	10.2	11.0	12.0	12.3	13.0	14.7	14.7	14.7	16.4	18.7
SWL 1:1/3:1 (kN)	26	26	31	31	31	37	30	28	28	28
SWL 19:1 (kN)	20	20	24	24	24	29	23	22	22	22
RM (kNm)	3.5	4.5	6.4	7.7	8.8	13.3	13.3	13.3	16.2	16.2

SL50 WIL

100mm outer leaf
50 - 65mm cavity
125 - 150mm inner leaf

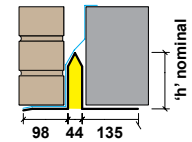

Not suitable to support precast concrete floors, attic trusses, heavy point loads.

STANDARD LENGTHS (mm) Lintels are available in increments of 150mm	600 1200	1350 1500	1650 2700	2850 3900	4050 4200				
Nominal Height "h" (mm)	140	153	190	225	225				
Weights (kg/m)	12.3	13.0	14.7	16.4	18.7				
SWL 1:1/3:1 (kN)	58	52	41	33	33				
SWL 19:1 (kN)	46	41	32	26	26				
RM (kNm)	7.7	8.8	13.3	15.5	16.2				

SL50 HD WIL

100mm outer leaf
50 - 65mm cavity
125 - 150mm inner leaf

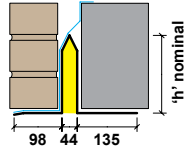

Not suitable to support precast concrete floors, attic trusses, heavy point loads.

STANDARD LENGTHS (mm) Lintels are available in increments of 150mm	600 1200	1350 1500	1650 1800	1950 2250	2400 2700				
Nominal Height "h" (mm)	153	185	190	225	225				
Weights (kg/m)	13.0	14.5	14.7	16.4	18.7				
SWL 1:1/3:1 (kN)	67	58	64	59	50				
SWL 19:1 (kN)	52	46	50	46	39				
RM (kNm)	8.8	9.9	13.3	15.5	16.2				

SL50 HDX WIL

100mm outer leaf
50 - 65mm cavity
125 - 150mm inner leaf

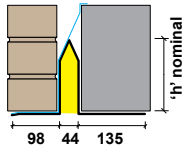

Not suitable to support precast concrete floors, attic trusses, heavy point loads.

STANDARD LENGTHS (mm) Lintels are available in increments of 150mm	600 2100	2250 2700	2850 3300	3450 3900	4050 4200				
Nominal Height "h" (mm)	225	225	225	225	225				
Weights (kg/m)	28.2	28.2	28.2	28.2	28.2				
SWL 5:1 (kN)	79	60	49	41	40				
SWL 19:1 (kN)	66	51	41	34	33				
RM (kNm)	20.6	20.6	20.6	20.6	20.6				

SL50 XHD 225 WIL

100mm outer leaf
50 - 65mm cavity
125 - 150mm inner leaf

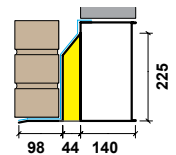

Suitable to support precast concrete floors, attic trusses, and point loads.

STANDARD LENGTHS (mm) Lintels are available in increments of 150mm	600 1800	1950 2100	2250 2400	2550 2700					
Nominal Height "h" (mm)	156	156	156	156					
Weights (kg/m)	16.3	16.3	16.3	16.3					
SWL 5:1 (kN)	72	62	53	41					
SWL 19:1 (kN)	61	52	45	34					
RM (kNm)	12.6	12.6	12.6	12.6					

See additional installation requirements on page 12.

SL50 CXHD 150 WIL

100mm outer leaf
50 - 65mm cavity
125 - 150mm inner leaf

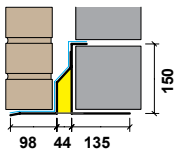

Suitable to support precast concrete floors, attic trusses, and point loads.

STANDARD LENGTHS (mm) Lintels are available in increments of 150mm	600 1800	1950 3000	3150 3900	4050 4500	4650 4800	4950 5100			
Nominal Height "h" (mm)	236	236	236	236	236	236			
Weights (kg/m)	20.1	20.1	20.1	20.1	20.1	20.1			
SWL 5:1 (kN)	89	71	55	42	37	32			
SWL 19:1 (kN)	75	60	46	40	35	30			
RM (kNm)	21.5	21.5	21.5	20.5	20.5	20.5			

See additional installation requirements on page 12.

SL50 CXHD 225 WIL

100mm outer leaf
50 - 65mm cavity
125 - 150mm inner leaf

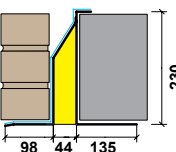

Suitable to support precast concrete floors, attic trusses, and point loads.

SL70 WIL

100mm outer leaf
70 - 85mm cavity
125-150mm inner leaf

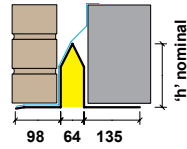

Not suitable to support precast concrete floors, attic trusses, heavy point loads.

STANDARD LENGTHS (mm)	600	1350	1650	1950	2250	2550	3150	3750	4050	4350
Lintels are available in increments of 150mm	1200	1500	1800	2100	2400	3000	3600	3900	4200	4800
Nominal Height "h" (mm)	95	113	134	140	153	190	190	190	225	225
Weights (kg/m)	10.4	11.3	12.3	12.6	13.2	15.0	15.0	15.0	16.6	19.4
SWL 1:1/3:1 (kN)	26	26	31	31	31	37	30	28	28	28
SWL 19:1 (kN)	20	20	24	24	24	29	23	22	22	22
RM (kNm)	3.5	4.5	6.4	7.7	8.8	13.3	13.3	13.3	16.2	16.2

SL70 HD WIL

100mm outer leaf
70 - 85mm cavity
125 -150mm inner leaf

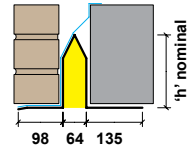

Not suitable to support precast concrete floors, attic trusses, heavy point loads.

STANDARD LENGTHS (mm)	600	1350	1650	2850	4050					
Lintels are available in increments of 150mm	1200	1500	2700	3900	4200					
Nominal Height "h" (mm)	140	153	190	225	225					
Weights (kg/m)	12.6	13.2	15.0	16.6	19.4					
SWL 1:1/3:1 (kN)	58	52	41	33	33					
SWL 19:1 (kN)	46	41	32	26	26					
RM (kNm)	7.7	8.8	13.3	15.5	16.2					

SL70 HDX WIL

100mm outer leaf
70 - 85mm cavity
125 -150mm inner leaf

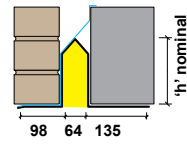

Not suitable to support precast concrete floors, attic trusses, heavy point loads.

STANDARD LENGTHS (mm)	600	1350	1650	1950	2400					
Lintels are available in increments of 150mm	1200	1500	1800	2250	2700					
Nominal Height "h" (mm)	153	185	190	225	225					
Weights (kg/m)	13.5	15.0	15.3	16.9	19.4					
SWL 1:1/3:1 (kN)	67	58	64	59	50					
SWL 19:1 (kN)	52	46	50	46	39					
RM (kNm)	8.8	9.9	13.3	15.5	16.2					

SL70 XHD 225 WIL

100mm outer leaf
70 - 85mm cavity
125 -150mm inner leaf

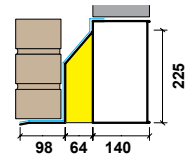

Suitable to support precast concrete floors, attic trusses, and point loads.

STANDARD LENGTHS (mm)	600	2250	2850	3450	4050					
Lintels are available in increments of 150mm	2100	2700	3300	3900	4200					
Nominal Height "h" (mm)	225	225	225	225	225					
Weights (kg/m)	29.1	29.1	29.1	29.1	29.1					
SWL 5:1 (kN)	79	60	49	41	40					
SWL 19:1 (kN)	66	51	41	34	33					
RM (kNm)	20.6	20.6	20.6	20.6	20.6					

SL70 CXHD 150 WIL

100mm outer leaf
70 - 85mm cavity
125 -150mm inner leaf

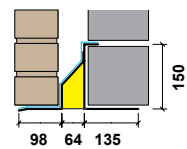

Suitable to support precast concrete floors, attic trusses, and point loads.

STANDARD LENGTHS (mm)	600	1950	2250	2550						
Lintels are available in increments of 150mm	1800	2100	2400	2700						
Nominal Height "h" (mm)	156	156	156	156						
Weights (kg/m)	17.2	17.2	17.2	17.2						
SWL 5:1 (kN)	72	62	53	41						
SWL 19:1 (kN)	61	52	45	34						
RM (kNm)	12.6	12.6	12.6	12.6						

See additional installation requirements on page 12.

SL70 CXHD 225 WIL

100mm outer leaf
70 - 85mm cavity
125 - 150mm inner leaf

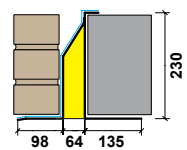

Suitable to support precast concrete floors, attic trusses, and point loads.

STANDARD LENGTHS (mm)	600	1950	3150	4050	4650	4950				
Lintels are available in increments of 150mm	1800	3000	3900	4500	4800	5100				
Nominal Height "h" (mm)	236	236	236	236	236	236				
Weights (kg/m)	20.9	20.9	20.9	20.9	20.9	20.9				
SWL 5:1 (kN)	89	71	55	42	37	32				
SWL 19:1 (kN)	75	60	46	40	35	30				
RM (kNm)	21.5	21.5	21.5	20.5	20.5	20.5				

See additional installation requirements on page 12.

STANDARD LENGTHS (mm) Lintels are available in increments of 150mm	600 1200	1350 1500	1650 1800	1950 2100	2250 2400	2550 3000	3150 3600	3750 3900	4050 4200	4350 4800
Nominal Height "h" (mm)	95	113	134	140	153	190	190	190	225	225
Weights (kg/m)	10.7	11.6	12.6	12.9	13.5	15.3	15.3	15.3	16.9	20.2
SWL 1:1/3:1 (kN)	26	26	31	31	31	37	30	28	28	28
SWL 19:1 (kN)	20	20	24	24	24	29	23	22	22	22
RM (kNm)	3.5	4.5	6.4	7.7	8.8	13.3	13.3	13.3	16.2	16.2

SL90 WIL

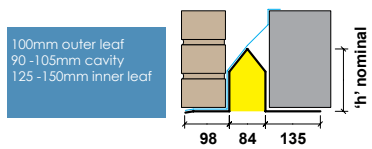

Not suitable to support precast concrete floors, attic trusses, heavy point loads.

STANDARD LENGTHS (mm) Lintels are available in increments of 150mm	600 1200	1350 1500	1650 2700	2850 3900	4050 4200					
Nominal Height "h" (mm)	140	153	190	225	225					
Weights (kg/m)	12.9	13.5	15.3	16.9	20.2					
SWL 1:1/3:1 (kN)	58	52	41	33	33					
SWL 19:1 (kN)	46	41	32	26	26					
RM (kNm)	7.7	8.8	13.3	15.5	16.2					

SL90 HD WIL

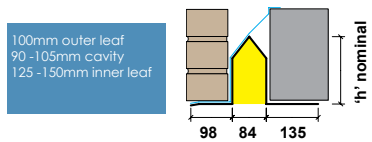

Not suitable to support precast concrete floors, attic trusses, heavy point loads.

STANDARD LENGTHS (mm) Lintels are available in increments of 150mm	600 1200	1350 1500	1650 1800	1950 2250	2400 2700					
Nominal Height "h" (mm)	153	185	190	225	225					
Weights (kg/m)	13.5	15.0	15.3	16.9	20.2					
SWL 1:1/3:1 (kN)	67	58	64	59	50					
SWL 19:1 (kN)	52	46	50	46	39					
RM (kNm)	8.8	9.9	13.3	15.5	16.2					

SL90 HDX WIL

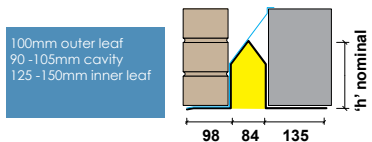

Not suitable to support precast concrete floors, attic trusses, heavy point loads.

STANDARD LENGTHS (mm) Lintels are available in increments of 150mm	600 2100	2250 2700	2850 3300	3450 3900	4050 4200					
Nominal Height "h" (mm)	225	225	225	225	225					
Weights (kg/m)	29.9	29.9	29.9	29.9	29.9					
SWL 5:1 (kN)	79	60	49	41	40					
SWL 19:1 (kN)	66	51	41	34	33					
RM (kNm)	20.6	20.6	20.6	20.6	20.6					

SL90 XHD 225 WIL

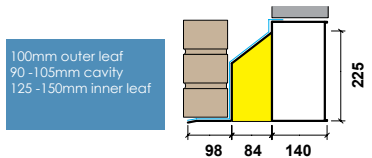

Suitable to support precast concrete floors, attic trusses, and point loads.

STANDARD LENGTHS (mm) Lintels are available in increments of 150mm	600 1800	1950 2100	2250 2400	2550 2700						
Nominal Height "h" (mm)	156	156	156	156						
Weights (kg/m)	18.0	18.0	18.0	18.0						
SWL 5:1 (kN)	72	62	53	41						
SWL 19:1 (kN)	61	52	45	34						
RM (kNm)	12.6	12.6	12.6	12.6						

See additional installation requirements on page 12.

SL90 CXHD 150 WIL

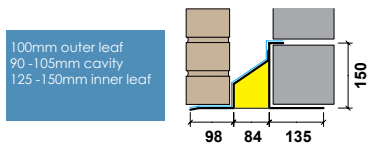

Suitable to support precast concrete floors, attic trusses, and point loads.

STANDARD LENGTHS (mm) Lintels are available in increments of 150mm	600 1800	1950 3000	3150 3900	4050 4500	4650 4800	4950 5100				
Nominal Height "h" (mm)	236	236	236	236	236	236				
Weights (kg/m)	21.8	21.8	21.8	21.8	21.8	21.8				
SWL 5:1 (kN)	89	71	55	42	37	32				
SWL 19:1 (kN)	75	60	46	40	35	30				
RM (kNm)	21.5	21.5	21.5	20.5	20.5	20.5				

See additional installation requirements on page 12.

SL90 CXHD 225 WIL

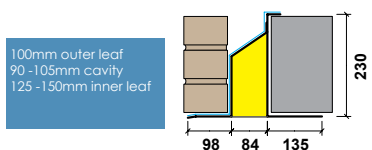

Suitable to support precast concrete floors, attic trusses, and point loads.

SL110 WIL

100mm outer leaf
110 - 125mm cavity
125 - 150mm inner leaf

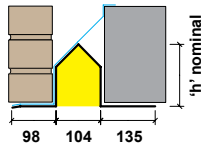

Not suitable to support precast concrete floors, attic trusses, heavy point loads.

STANDARD LENGTHS (mm)	600	1350	1650	1950	2250	2550	3150	3750	4050	4350
Lintels are available in increments of 150mm	1200	1500	1800	2100	2400	3000	3600	3900	4200	4800
Nominal Height "h" (mm)	95	113	134	140	153	190	190	190	225	225
Weights (kg/m)	11.5	12.4	13.4	13.7	14.3	16.1	16.1	16.1	17.7	21.5
SWL 1:1/3:1 (kN)	26	26	31	31	31	37	30	28	28	28
SWL 19:1 (kN)	20	20	24	24	24	29	23	22	22	22
RM (kNm)	3.5	4.5	6.4	7.7	8.8	13.3	13.3	13.3	16.2	16.2

SL110 HD WIL

100mm outer leaf
110 - 125mm cavity
125 - 150mm inner leaf

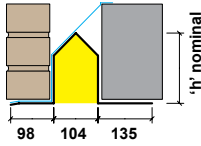

Not suitable to support precast concrete floors, attic trusses, heavy point loads.

STANDARD LENGTHS (mm)	600	1350	1650	2850	4050				
Lintels are available in increments of 150mm	1200	1500	2700	3900	4200				
Nominal Height "h" (mm)	140	153	190	225	225				
Weights (kg/m)	13.7	14.3	16.1	17.7	21.5				
SWL 1:1/3:1 (kN)	58	52	41	33	33				
SWL 19:1 (kN)	46	41	32	26	26				
RM (kNm)	7.7	8.8	13.3	15.5	16.2				

SL110 HDX WIL

100mm outer leaf
110 - 125mm cavity
125 - 150mm inner leaf

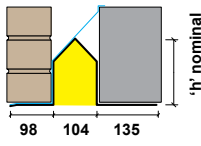

Not suitable to support precast concrete floors, attic trusses, heavy point loads.

STANDARD LENGTHS (mm)	600	1350	1650	1950	2400				
Lintels are available in increments of 150mm	1200	1500	1800	2250	2700				
Nominal Height "h" (mm)	153	185	190	225	225				
Weights (kg/m)	14.3	15.8	16.1	17.7	21.5				
SWL 1:1/3:1 (kN)	67	58	64	59	50				
SWL 19:1 (kN)	52	46	50	49	39				
RM (kNm)	8.8	9.9	13.3	46	16.2				

SL110 XHD 225 WIL

100mm outer leaf
110 - 125mm cavity
125 - 150mm inner leaf

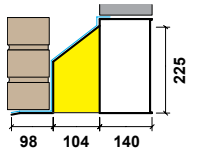

Suitable to support precast concrete floors, attic trusses, and point loads.

STANDARD LENGTHS (mm)	600	2250	2850	3450	4050				
Lintels are available in increments of 150mm	2100	2700	3300	3900	4200				
Nominal Height "h" (mm)	225	225	225	225	225				
Weights (kg/m)	30.8	30.8	30.8	30.8	30.8				
SWL 5:1 (kN)	79	60	49	41	40				
SWL 19:1 (kN)	66	51	41	34	33				
RM (kNm)	20.6	20.6	20.6	20.6	20.6				

SL110 CXHD 150 WIL

100mm outer leaf
110 - 125mm cavity
125 - 150mm inner leaf

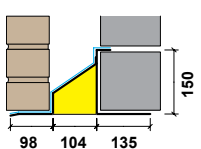

Suitable to support precast concrete floors, attic trusses, and point loads.

STANDARD LENGTHS (mm)	600	1950	2250	2550				
Lintels are available in increments of 150mm	1800	2100	2400	2700				
Nominal Height "h" (mm)	156	156	156	156				
Weights (kg/m)	18.9	18.9	18.9	18.9				
SWL 5:1 (kN)	72	62	53	41				
SWL 19:1 (kN)	61	52	45	34				
RM (kNm)	12.6	12.6	12.6	12.6				

See additional installation requirements on page 12.

SL110 CXHD 225 WIL

100mm outer leaf
110 - 125mm cavity
125 - 150mm inner leaf

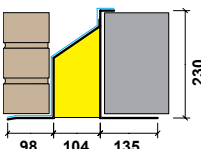

Suitable to support precast concrete floors, attic trusses, and point loads.

STANDARD LENGTHS (mm)	600	1950	3150	4050	4650	4950		
Lintels are available in increments of 150mm	1800	3000	3900	4500	4800	5100		
Nominal Height "h" (mm)	236	236	236	236	236	236		
Weights (kg/m)	22.7	22.7	22.7	22.7	22.7	22.7		
SWL 5:1 (kN)	89	71	55	42	37	32		
SWL 19:1 (kN)	75	60	46	40	35	30		
RM (kNm)	21.5	21.5	21.5	20.5	20.5	20.5		

See additional installation requirements on page 12.

STANDARD LENGTHS (mm) Lintels are available in increments of 150mm	600 1200	1350 1500	1650 1800	1950 2100	2250 2400	2550 3000	3150 3600	3750 3900	4050 4200	4350 4800
Nominal Height "h" (mm)	95	113	134	140	153	190	190	190	225	225
Weights (kg/m)	11.9	12.7	13.7	14.0	14.6	16.4	16.4	16.4	18.1	22.3
SWL 1:1/3:1 (kN)	26	26	31	31	31	37	30	28	28	28
SWL 19:1 (kN)	20	20	24	24	24	29	23	22	22	22
RM (kNm)	3.5	4.5	6.4	7.7	8.8	13.3	13.3	13.3	16.2	16.2

SL130 WIL

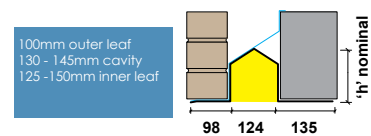

Not suitable to support precast concrete floors, attic trusses, heavy point loads.

STANDARD LENGTHS (mm) Lintels are available in increments of 150mm	600 1200	1350 1500	1650 2700	2850 3900	4050 4200					
Nominal Height "h" (mm)	140	153	190	225	225					
Weights (kg/m)	14.0	14.6	16.4	18.1	22.3					
SWL 1:1/3:1 (kN)	58	52	41	33	33					
SWL 19:1 (kN)	46	41	32	26	26					
RM (kNm)	7.7	8.8	13.3	15.5	16.2					

SL130 HD WIL

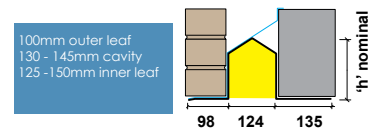

Not suitable to support precast concrete floors, attic trusses, heavy point loads.

STANDARD LENGTHS (mm) Lintels are available in increments of 150mm	600 1200	1350 1500	1650 1800	1950 2250	2400 2700					
Nominal Height "h" (mm)	153	185	190	225	225					
Weights (kg/m)	14.6	16.2	16.4	18.1	18.7					
SWL 1:1/3:1 (kN)	67	58	64	59	50					
SWL 19:1 (kN)	52	46	50	46	39					
RM (kNm)	8.8	9.9	13.3	15.5	16.2					

SL130 HDX WIL

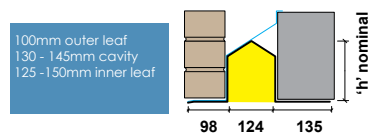

Not suitable to support precast concrete floors, attic trusses, heavy point loads.

STANDARD LENGTHS (mm) Lintels are available in increments of 150mm	600 2100	2250 2700	2850 3300	3450 3900	4050 4200					
Nominal Height "h" (mm)	225	225	225	225	225					
Weights (kg/m)	31.7	31.7	31.7	31.7	31.7					
SWL 5:1 (kN)	79	60	49	41	40					
SWL 19:1 (kN)	66	51	41	34	33					
RM (kNm)	20.6	20.6	20.6	20.6	20.6					

SL130 XHD 225 WIL

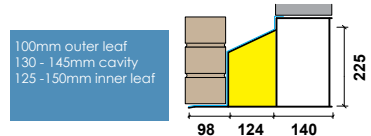

Suitable to support precast concrete floors, attic trusses, and point loads.

STANDARD LENGTHS (mm) Lintels are available in increments of 150mm	600 1800	1950 2100	2250 2400	2550 2700						
Nominal Height "h" (mm)	156	156	156	156						
Weights (kg/m)	19.8	19.8	19.8	19.8						
SWL 5:1 (kN)	72	62	53	41						
SWL 19:1 (kN)	61	52	45	34						
RM (kNm)	12.6	12.6	12.6	12.6						

SL130 CXHD 150 WIL

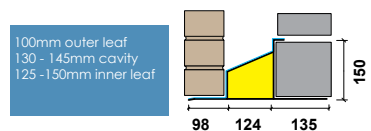

Suitable to support precast concrete floors, attic trusses, and point loads.

STANDARD LENGTHS (mm) Lintels are available in increments of 150mm	600 1800	1950 3000	3150 3900	4050 4500	4650 4800	4950 5100				
Nominal Height "h" (mm)	236	236	236	236	236	236				
Weights (kg/m)	23.6	23.6	23.6	23.6	23.6	23.6				
SWL 5:1 (kN)	89	71	55	42	37	32				
SWL 19:1 (kN)	75	60	46	40	35	30				
RM (kNm)	21.5	21.5	21.5	20.5	20.5	20.5				

SL130 CXHD 225 WIL

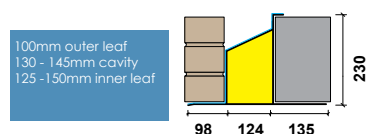

Suitable to support precast concrete floors, attic trusses, and point loads.

CAVITY 130 WIL

SL150 WIL

100mm outer leaf
150 - 165mm cavity
125 - 150mm inner leaf

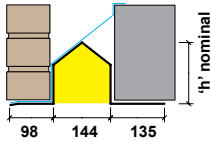

Not suitable to support precast concrete floors, attic trusses, heavy point loads.

STANDARD LENGTHS (mm)	600	1350	1650	1950	2250	2550	3150	3750	4050	4350
Lintels are available in increments of 150mm	1200	1500	1800	2100	2400	3000	3600	3900	4200	4800
Nominal Height "h" (mm)	95	113	134	140	153	190	190	190	225	225
Weights (kg/m)	12.3	13.1	14.1	14.1	14.4	16.8	16.8	16.8	18.5	23.2
SWL 1:1/3:1 (kN)	26	26	31	31	31	37	30	28	28	28
SWL 19:1 (kN)	20	20	24	24	24	29	23	22	22	22
RM (kNm)	3.5	4.5	6.4	7.7	8.8	13.3	13.3	13.3	16.2	16.2

SL150 HD WIL

100mm outer leaf
150 - 165mm cavity
125 - 150mm inner leaf

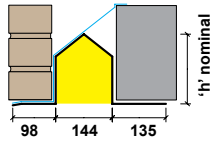

Not suitable to support precast concrete floors, attic trusses, heavy point loads.

STANDARD LENGTHS (mm)	600	1350	1650	2850	4050					
Lintels are available in increments of 150mm	1200	1500	2700	3900	4200					
Nominal Height "h" (mm)	140	153	190	225	225					
Weights (kg/m)	14.4	15.1	16.8	18.5	23.2					
SWL 1:1/3:1 (kN)	58	52	41	33	33					
SWL 19:1 (kN)	46	41	32	26	26					
RM (kNm)	7.7	8.8	13.3	15.5	16.2					

SL150 HDX WIL

100mm outer leaf
150 - 165mm cavity
125 - 150mm inner leaf

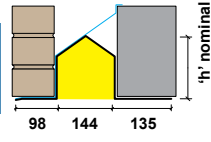

Not suitable to support precast concrete floors, attic trusses, heavy point loads.

STANDARD LENGTHS (mm)	600	1350	1650	1950	2400					
Lintels are available in increments of 150mm	1200	1500	1800	2250	2700					
Nominal Height "h" (mm)	153	185	190	225	225					
Weights (kg/m)	15.1	16.6	16.8	18.5	23.2					
SWL 1:1/3:1 (kN)	67	58	64	59	50					
SWL 19:1 (kN)	52	46	50	46	39					
RM (kNm)	8.8	9.9	13.3	15.5	16.2					

SL150 XHD 225 WIL

100mm outer leaf
150 - 165mm cavity
125 - 150mm inner leaf

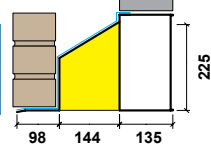

Suitable to support precast concrete floors, attic trusses, and point loads.

STANDARD LENGTHS (mm)	600	2250	2850	3450	4050					
Lintels are available in increments of 150mm	2100	2700	3300	3900	4200					
Nominal Height "h" (mm)	225	225	225	225	225					
Weights (kg/m)	32.6	32.6	32.6	32.6	32.6					
SWL 5:1 (kN)	79	60	49	41	40					
SWL 19:1 (kN)	66	51	41	34	33					
RM (kNm)	20.6	20.6	20.6	20.6	20.6					

SL150 CXHD 150 WIL

100mm outer leaf
150 - 165mm cavity
125 - 150mm inner leaf

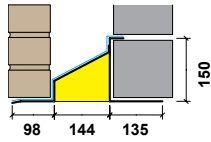

Suitable to support precast concrete floors, attic trusses, and point loads.

STANDARD LENGTHS (mm)	600	1950	2250	2550						
Lintels are available in increments of 150mm	1800	2100	2400	2700						
Nominal Height "h" (mm)	156	156	156	156						
Weights (kg/m)	20.8	20.8	20.8	20.8						
SWL 5:1 (kN)	72	62	53	41						
SWL 19:1 (kN)	61	52	45	34						
RM (kNm)	12.6	12.6	12.6	12.6						

See additional installation requirements on page 12.

SL150 CXHD 225 WIL

100mm outer leaf
150 - 165mm cavity
125 - 150mm inner leaf

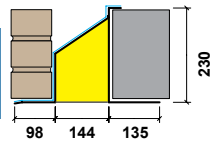

Suitable to support precast concrete floors, attic trusses, and point loads.

STANDARD LENGTHS (mm)	600	1950	3150	4050	4650	4950				
Lintels are available in increments of 150mm	1800	3000	3900	4500	4800	5100				
Nominal Height "h" (mm)	236	236	236	236	236	236				
Weights (kg/m)	24.5	24.5	24.5	24.5	24.5	24.5				
SWL 5:1 (kN)	89	71	55	42	37	32				
SWL 19:1 (kN)	75	60	46	40	35	30				
RM (kNm)	21.5	21.5	21.5	20.5	20.5	20.5				

See additional installation requirements on page 12.