



PRESTRESSED CONCRETE FAIR FACED LINTELS



APPLICATION

This type of lintel is specifically used in fair faced block/brick walls. It can be painted if required.

Designed to support:

- Masonry loads
- Uniformly distributed timber floor loads
- Uniformly distributed roof loads
- Concrete floor loads
- Attic truss loads
- Point loads: compound trusses, steel beams, etc

ALWAYS CHECK LOADINGS AGAINST OUR
LOAD-SPAN TABLE

INSTALLATION NOTES

For general installation notes please refer to page 67.

Additional installation requirements for lintels supporting concrete floor units

- Check that the correct lintel has been installed.
- Minimum recommended lintel depth is 140mm in order to absorb the shock loading of concrete floor. Precast flooring units should be laid on a mortar bed across the whole wall width and should not be dragged over supports.

ADVANTAGES

- A cost effective, high performance range of lintels with a smooth fair faced finish
- We offer a wide range of lintels from 100 x 110 through to 215 x 215 with further sections available in the near future.
- If required, Stressline can schedule and deliver in house plots.

IMPORTANT NOTES

- The loading figures published in the load-span tables represent the Uniform Distributed Serviceable Load (UDL) in kN/m which can be supported by the lintel without the provision of structural brickwork/blockwork over. This is known as Independent Design.
- Lintels are marked TOP and must be used in the correct orientation

ABBREVIATIONS

UDL – Uniform Distributed Load (Serviceable)
RM – Resistance Moment (Serviceable)



If in doubt please contact
our technical department on
01455 272457

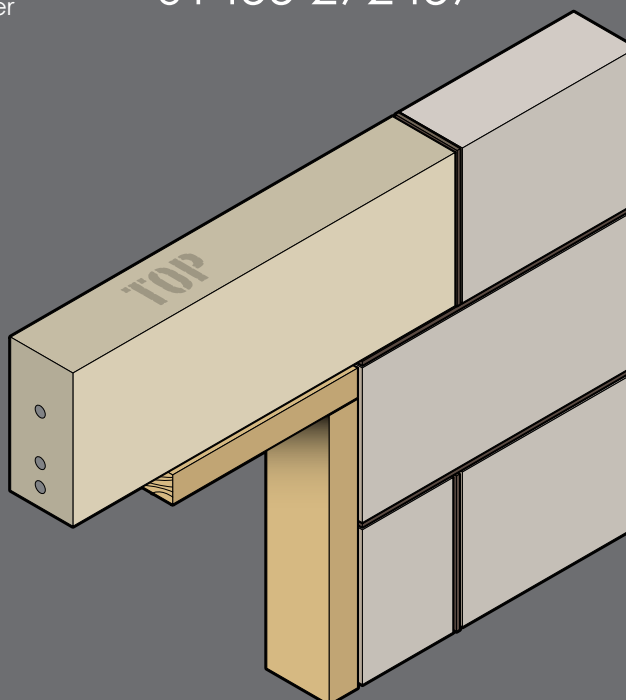

100 x 110 Fair Faced

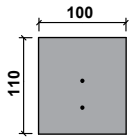

STANDARD LENGTHS (mm)	900	1200	1500	1800	2100	2400	2700	3000				
Clear Span (mm)	600	900	1200	1500	1800	2100	2400	2700				
Weight (Kg/m)	26.9	26.9	26.9	26.9	26.9	26.9	26.9	26.9				
UDL (kN/m)	43.5*	24.1	14.0	9.1	6.3	4.7	3.5	2.8				
RM (kNm)	2.9	2.9	2.9	2.9	2.9	2.9	2.9	2.9				

*UDL is restricted by shear
Minimum manufactured length is 900mm Maximum manufactured length is 3000mm

100 x 140 Fair Faced

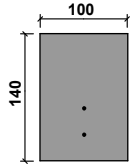

STANDARD LENGTHS (mm)	900	1200	1500	1800	2100	2400	2700	3000	3300	3600	4050	4200
Clear Span (mm)	600	900	1200	1500	1800	2100	2400	2700	3000	3300	3600	3900
Weight (Kg/m)	34.3	34.3	34.3	34.3	34.3	34.3	34.3	34.3	34.3	34.3	34.3	34.3
UDL (kN/m)	56.2*	40.9	26.4	17.3	12.1	9.0	6.8	5.4	4.3	3.5	2.9	2.2
RM (kNm)	5.6	5.6	5.6	5.6	5.6	5.6	5.6	5.6	5.6	5.6	5.6	5.6

*UDL is restricted by shear
Minimum manufactured length is 900mm Maximum manufactured length is 4200mm

100 x 215 Fair Faced

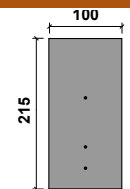

STANDARD LENGTHS (mm)	900	1200	1500	1800	2100	2400	2700	3000	3300	3600	4050	4200
Clear Span (mm)	600	900	1200	1500	1800	2100	2400	2700	3000	3300	3600	3900
Weight (Kg/m)	52.6	52.6	52.6	52.6	52.6	52.6	52.6	52.6	52.6	52.6	52.6	52.6
UDL (kN/m)	81.5*	62.9	49.1	36.6	26.0	19.4	15.0	11.9	9.6	7.9	6.6	5.6
RM (kNm)	12.5	12.5	12.5	12.5	12.5	12.5	12.5	12.5	12.5	12.5	12.5	12.5

*UDL is restricted by shear
Minimum manufactured length is 900mm Maximum manufactured length is 4200mm

140 x 100 Fair Faced

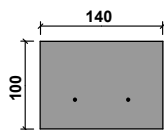

STANDARD LENGTHS (mm)	900	1200	1500	1800	2100	2400	2700	3000				
Clear Span (mm)	600	900	1200	1500	1800	2100	2400	2700				
Weight (Kg/m)	34.3	34.3	34.3	34.3	34.3	34.3	34.3	34.3				
UDL (kN/m)	54.7*	33.2	19.2	12.5	8.7	6.4	4.8	3.8				
RM (kNm)	3.9	3.9	3.9	3.9	3.9	3.9	3.9	3.9				

*UDL is restricted by shear
Minimum manufactured length is 900mm Maximum manufactured length is 3000mm

140 x 140 Fair Faced

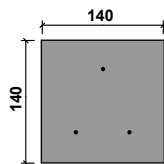

STANDARD LENGTHS (mm)	900	1200	1500	1800	2100	2400	2700	3000	3300	3600	4050	4200
Clear Span (mm)	600	900	1200	1500	1800	2100	2400	2700	3000	3300	3600	3900
Weight (Kg/m)	48.0	48.0	48.0	48.0	48.0	48.0	48.0	48.0	48.0	48.0	48.0	48.0
UDL (kN/m)	71.9*	52.8	34.6	22.7	16.0	11.8	9.1	7.1	5.7	4.7	3.9	3.3
RM (kNm)	7.5	7.5	7.5	7.5	7.5	7.5	7.5	7.5	7.5	7.5	7.5	7.5

*UDL is restricted by shear
Minimum manufactured length is 900mm Maximum manufactured length is 4200mm

140 x 215 Fair Faced

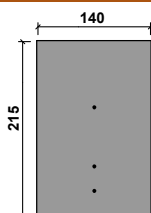

STANDARD LENGTHS (mm)	900	1200	1500	1800	2100	2400	2700	3000	3300	3600	4050	4200
Clear Span (mm)	600	900	1200	1500	1800	2100	2400	2700	3000	3300	3600	3900
Weight (Kg/m)	73.7	73.7	73.7	73.7	73.7	73.7	73.7	73.7	73.7	73.7	73.7	73.7
UDL (kN/m)	104.2*	81.7	63.1	43.6	30.9	23.0	17.8	14.1	11.4	9.5	7.8	7.3
RM (kNm)	14.9	14.9	14.9	14.9	14.9	14.9	14.9	14.9	14.9	14.9	14.9	14.9

STANDARD LENGTHS (mm)	900	1200	1500	1800	2100	2400	2700	3000	3300	3600	4050	4200
Clear Span (mm)	600	900	1200	1500	1800	2100	2400	2700	3000	3300	3600	3900
Weight (Kg/m)	113.2	113.2	113.2	113.2	113.2	113.2	113.2	113.2	113.2	113.2	113.2	113.2
UDL (kN/m)	143.0*	112.4*	77.8	51.6	36.5	27.1	20.9	16.5	13.3	10.9	9.0	7.6
RM (kNm)	17.7	17.7	17.7	17.7	17.7	17.7	17.7	17.7	17.7	17.7	17.7	17.7

*UDL is restricted by shear
 Minimum manufactured length is 900mm Maximum manufactured length is 4200mm

215 x 215 Fair Faced

